

1. Start the device, enter the home page, insert the USB drive, and the USB drive icon will appear in the top status bar, indicating that the USB drive has been successfully recognized.

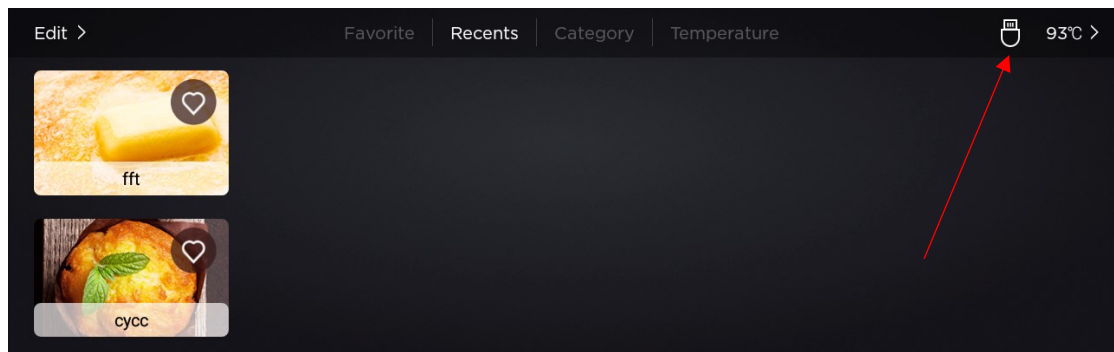

2. Click **SETTING** the button in the navigation bar at the bottom of the screen to enter the settings interface. Click the " User Setting " card button to enter the user settings interface. You need to enter the password for the first time.

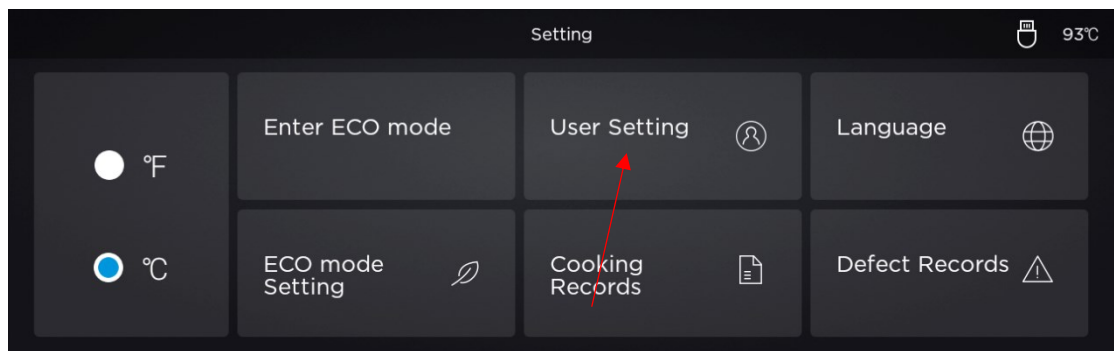

3. The default password is " flashtune"

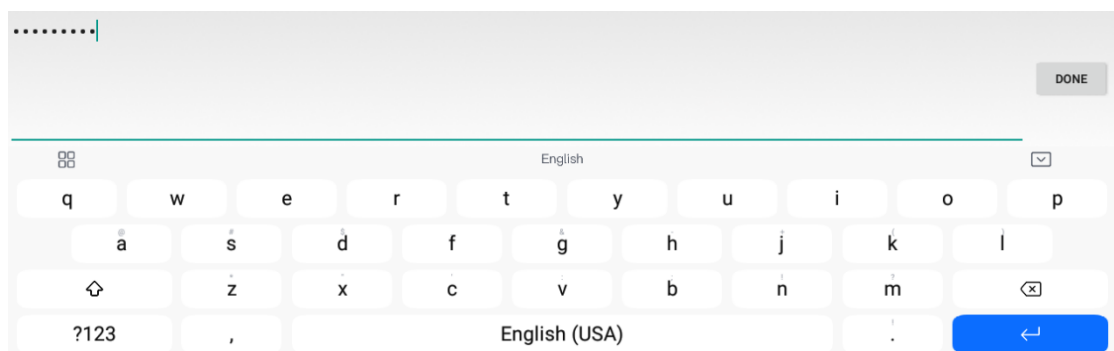
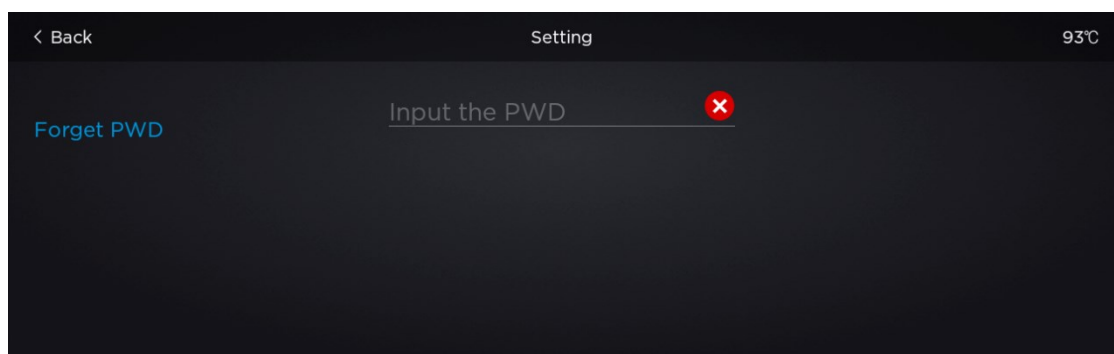

4. Enter User After the Setting interface, click the USB card button to enter the USB interface

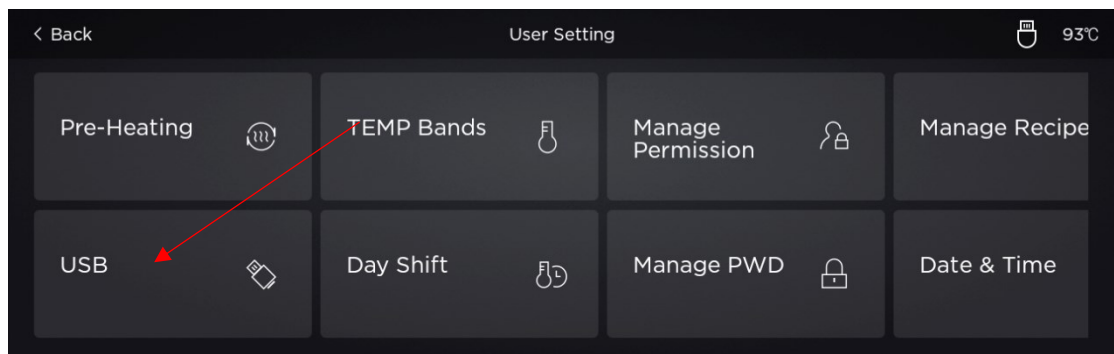

5. Click the Recipes Upload option to enter the recipe file selection interface, find the recipe file to be imported, and click the corresponding icon to start importing

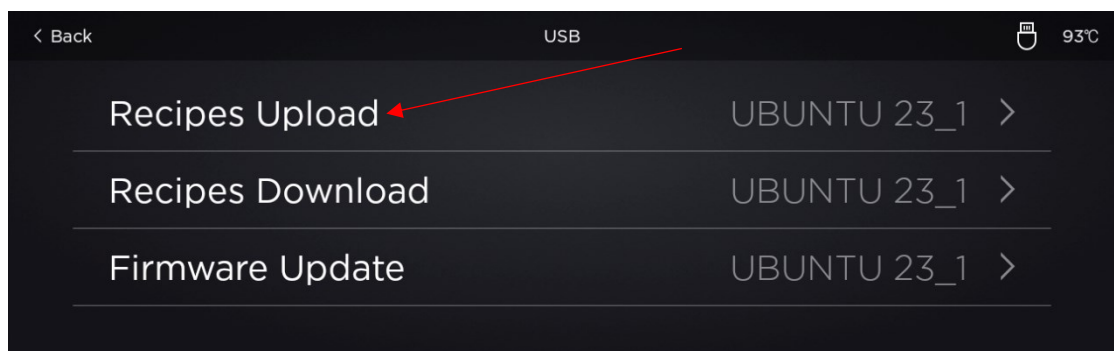

6. If the import is successful, a pop-up window will display Success, and the file icon will display a success mark



7. If the import fails, a pop-up window will display "failed"

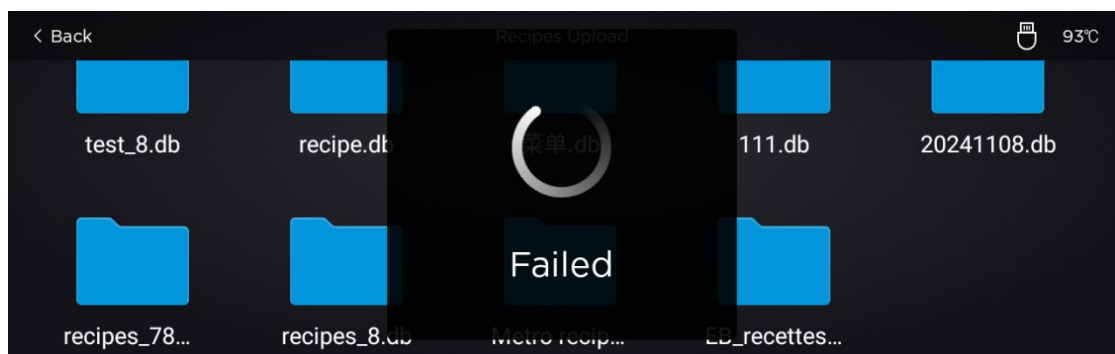

8. Click the button at the bottom of the screen **MENU** to return to the home page and check if the recipe is successfully displayed

